

A close-up photograph of several industrial connectors, likely made of metal, with a blue protective cap on one. The connectors are covered in water droplets, suggesting a wet or high-pressure environment. The image is partially obscured by a large blue diagonal graphic element on the left side of the page.

CONNECTOR

SOLUTIONS

2018v1

CONNECTOR SOLUTIONS



TTAF Elektronik Ltd was founded in Istanbul /Turkey in 2003, providing interconnect solutions for industrial, telecom and led lighting applications including: Wiring harnesses, Cable Assemblies, Optical Fiber, Power, RF, Molded, Electromechanical Assemblies, Lighting Systems and IP rated outdoor solutions.

Servicing our diverse customers worldwide from our state of the art manufacturing facilities in Istanbul(6000sqm closed area), TTAF is now a global interconnect solutions and cable assembly leader always valuing customer satisfaction.

After more than 30 years in the connector marketplace, TTAF capitalized to create own wire harness and cable assembly business offering wiring harness assemblies using optimum grade wire and other material with the help of cutting-edge machines in adherence to set electronic industry norms.

TTAF is ISO9001:2015, TSE, IPC/WHMA-A-620B, UL, CE, ATEX, ETL & 3P certified to meet even the most demanding quality standards.



W/P Connectors and Electrical Splitters

Table of Contents

3 Pin I Type OD:1.4mm Screw Connection Field Assembly	3
3 Pin T Type OD:1.4mm Screw Connection Field Assembly	4
2 Pin Pluggable Screw Connection Field Assembly	5
3 Pin Pluggable Screw Connection Field Assembly	6
4 Pin Pluggable Screw Connection Field Assembly	7
3 Pin I Type Silicone Oring Screw Connection Field Assembly	8
3 Pin I Type TPE Oring Screw Connection Field Assembly	9
3 Pin I Type Push in Wire Field Assembly	10
3 Pin Panel Type Screw Connection Field Assembly	11
3 Pin T Type Screw Connection Field Assembly	12
6 Pin Power I Type Screw Connection Field Assembly	13
3 Power + 6 Data I Type Screw Connection Field Assembly	14
6 Pin Power T Type Screw Connection Field Assembly	15
2 Pin Male Pluggable Field Assembly 1in 3 out	16
2 Pin Female Pluggable Field Assembly 1in 3 out	17
3 Pin Male Pluggable Field Assembly 1in 3 out	18
3 Pin Female Pluggable Field Assembly 1in 3 out	19
4 Pin Male Pluggable Field Assembly 1in 3 out	20
4 Pin Female Pluggable Field Assembly 1in 3 out	21
3 Pin Screw Connection Field Assembly 1in 3 out	22
3 Pin Screw Connection Field Assembly 1in 5 out	23
IP BOX WP-BOX-04	24
IP BOX WP-BOX-05	25
Cable Joints IPJ50 Series	26
Cable Joints IPJ24 Series	27
Mini Blade Fuse Type WFH-M Series	28
Mini Blade Fuse Type WFH-K Series	29

PRODUCTION, DESIGN AND TOOLING...

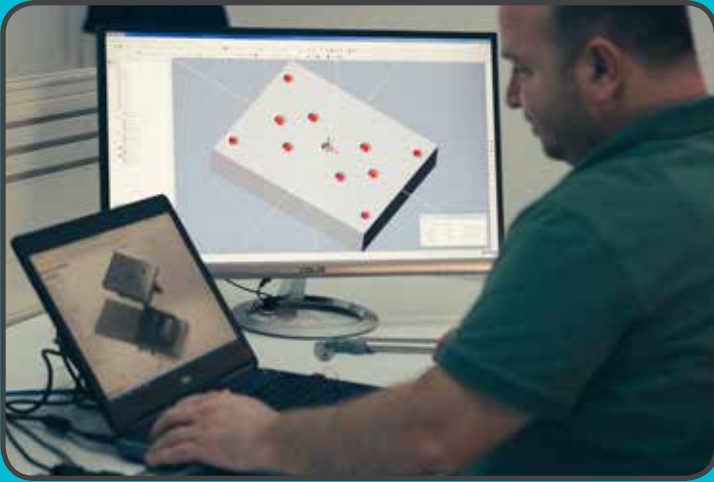

3 Pin I Type OD:14mm
Screw Connection
Field Assembly

WPI Series

3 pin
250 VAC
20A

Connector

CE EN 60309-1
EN 60695-2
EN 61984-2009



GONTUANA
Waterproof Connector Series

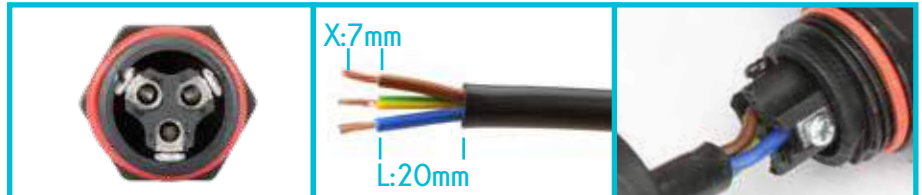

Technical Specifications

Product Code

WPI-0302M20/14

Number of Poles	3
Voltage Rating	250VAC max.
Current Rating	20A max.
Cable Cross Section Area	0,5mm ² ~ 2.5mm ²
Durability Voltage	1500VAC@60s.
Insulation Structure	500 MΩ at 500VDC
Contact Resistance	10 mΩ max.
Min Wire Size OD	6,5mm ~ 10mm
Max Wire Size OD	10,5mm ~ 14mm
Temperature Rating	-40°C ~ +85°C
IP Class	IP68 (10m / 60min)
Mold Material	PA6
Contact/Terminal Material	Nickel-Plated Brass
Seal Material	Silicone

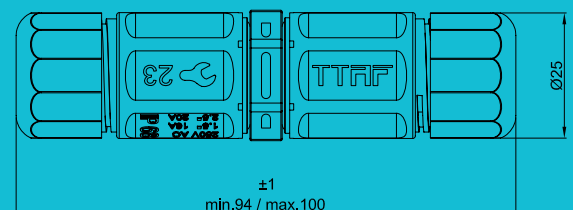
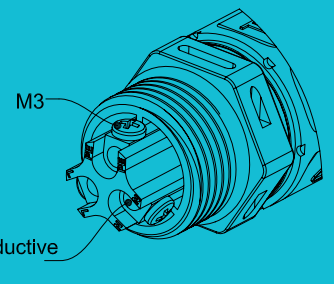

3 Pin T Type OD:14mm
Screw Connection
Field Assembly

WPT Series

3 pin
250 VAC
20A

Connector

CE EN 60309-1
EN 60695-2
EN 61984-2009



GONTUANA
Waterproof Connector Series

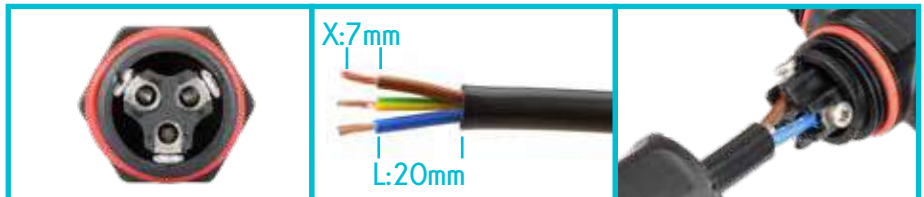

Technical Specifications

Product Code
WPT-0303M20/14

Number of Poles	3
Voltage Rating	250VAC max.
Current Rating	20A max.
Cable Cross Section Area	0,5mm ² ~ 2,5mm ²
Durability Voltage	1500VAC@60s.
Insulation Structure	500 MΩ at 500VDC
Contact Resistance	10 mΩ max.
Min Wire Size OD	6,5mm ~ 10mm
Max Wire Size OD	10,5mm ~ 14mm
Temperature Rating	-40°C ~ +85°C
IP Class	IP68 (10m / 60min)
Mold Material	PA6
Contact/Terminal Material	Nickel-Plated Brass
Seal Material	Silicone

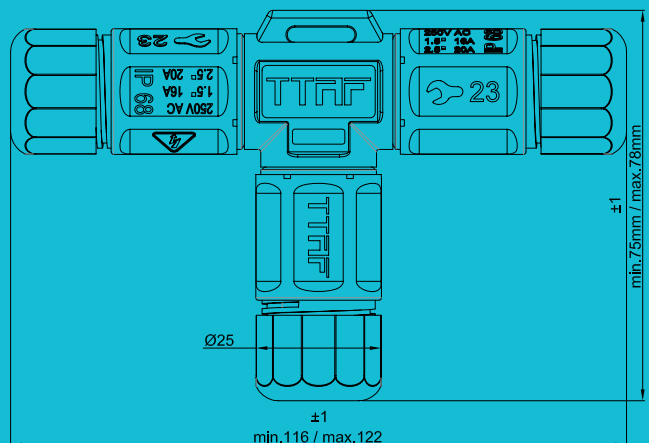
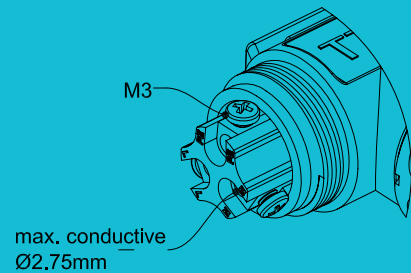

2 Pin Pluggable Screw Connection Field Assembly

Connectors

WPM-WPF-WPP Series

2 pin
250 VAC
20A



WPM-0200M20

2 Pin Male Cable Type



WPF-0200M20

2 Pin Female Cable Type



WPP-0200M20

2 Pin Male Panel Type

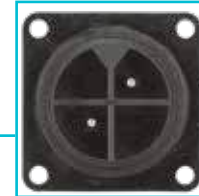

GONTUANA
Waterproof Connector Series

Technical Specifications

Product Codes

Number of Poles	2
Voltage Rating	250VAC max.
Current Rating	20A max.
Cable Cross Section Area	0,5mm ² ~ 2,5mm ²
Durability Voltage	3000VAC@60s.
Insulation Structure	500 MΩ at 500VDC
Contact Resistance	30 mΩ max.
Min Wire Size OD	6mm
Max Wire Size OD	10mm
Temperature Rating	-40°C ~ +85°C
IP Class	IP68 (10m / 60min)
Mold Material	PA6
Contact/Terminal Material	Nickel-Plated Brass
Seal Material	Silicone

WPM-0200M20
WPF-0200M20
WPP-0200M20

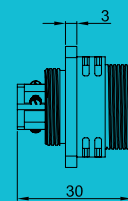
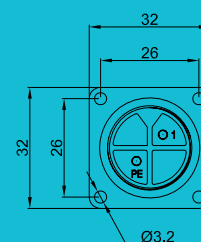
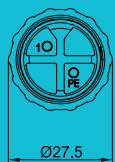
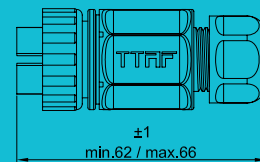
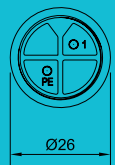
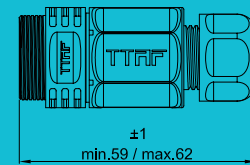

3 Pin Pluggable Screw Connection Field Assembly

Connectors

WPM-WPF-WPP Series

3 pin
250 VAC
20A



WPM-0300M20

3 Pin Male Cable Type



WPF-0300M20

3 Pin Female Cable Type



WPP-0300M20

3 Pin Male Panel Type

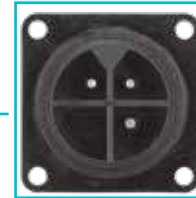

GONTUANA®

Waterproof Connector Series

Technical Specifications

Number of Poles
Voltage Rating
Current Rating
Cable Cross Section Area
Durability Voltage
Insulation Structure
Contact Resistance
Min Wire Size OD
Max Wire Size OD
Temperature Rating
IP Class
Mold Material
Contact/Terminal Material
Seal Material

Product Codes

WPM-0300M20
WPF-0300M20
WPP-0300M20

3
250VAC max.
20A max.
0,5mm² ~ 2,5mm²
3000VAC@60s.
500 MΩ at 500VDC
30 mΩ max.
6mm
10mm
-40°C ~ +85°C
IP68 (10m / 60min)
PA6
Nickel-Plated Brass
Silicone

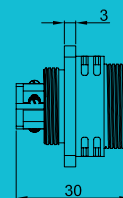
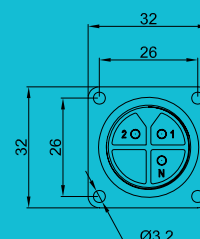
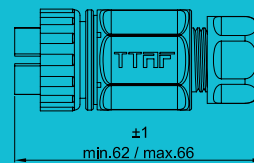
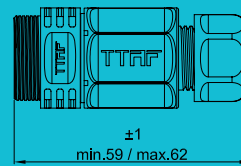

4 Pin Pluggable Screw Connection Field Assembly

Connectors

WPM-WPF-WPP Series

4 pin
250 VAC
20A



WPM-0400M20

4 Pin Male Cable Type



WPF-0400M20

4 Pin Female Cable Type



WPP-0400M20

4 Pin Male Panel Type

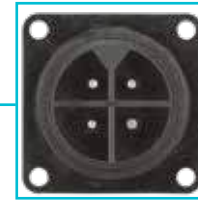

GONTUANA

Waterproof Connector Series

Technical Specifications

Product Codes

WPM-0400M20
WPF-0400M20
WPP-0400M20

Number of Poles	4
Voltage Rating	250VAC max.
Current Rating	20A max.
Cable Cross Section Area	0,5mm ² ~ 2,5mm ²
Durability Voltage	3000VAC@60s.
Insulation Structure	500 MΩ at 500VDC
Contact Resistance	30 mΩ max.
Min Wire Size OD	6mm
Max Wire Size OD	10mm
Temperature Rating	-40°C ~ +85°C
IP Class	IP68 (10m / 60min)
Mold Material	PA6
Contact/Terminal Material	Nickel-Plated Brass
Seal Material	Silicone

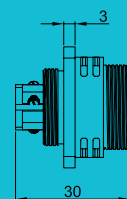
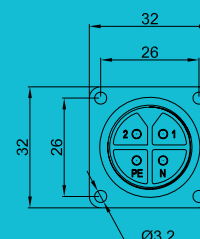
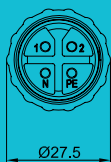
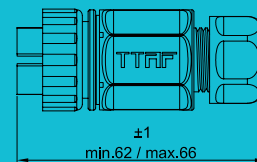
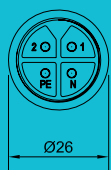
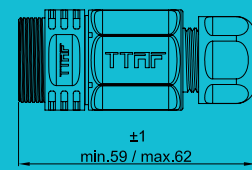

3 Pin I Type Screw Connection Field Assembly

Connector

3 pin
250 VAC
20A

WPI Series

CE EN 60309-1
EN 60695-2
EN 61984-2009



GONTUANA
Waterproof Connector Series

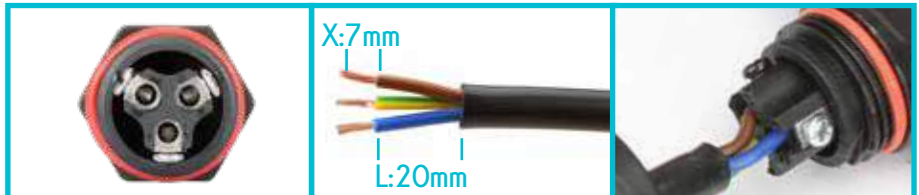

Technical Specifications

Product Code

WPI-0302M20

Number of Poles	3
Voltage Rating	250VAC max.
Current Rating	20A max.
Cable Cross Section Area	0,5mm ² ~ 2.5mm ²
Durability Voltage	1500VAC@60s.
Insulation Structure	500 MΩ at 500VDC
Contact Resistance	10 mΩ max.
Min Wire Size OD	6mm
Max Wire Size OD	10mm
Temperature Rating	-40°C ~ +85°C
IP Class	IP68 (10m / 60min)
Mold Material	PA6
Contact/Terminal Material	Nickel-Plated Brass
Seal Material	Silicone

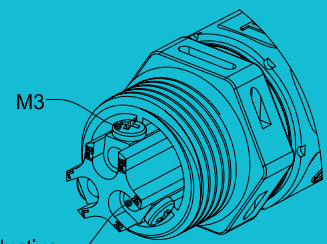

max. conductive
Ø2.75mm

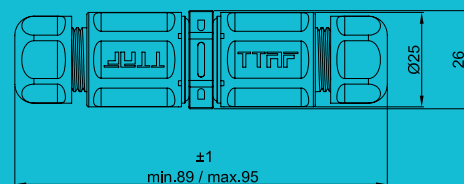

3 Pin I Type Screw Connection Field Assembly

WPI Series

Connectors

3 pin
250 VAC
20A



GONTUANA®
Waterproof Connector Series

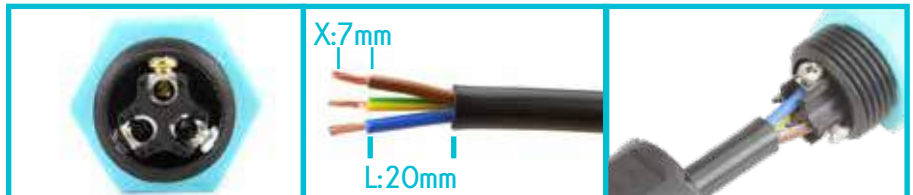

Technical Specifications

Product Code
WPI-0302M20/U2

Number of Poles	3
Voltage Rating	250VAC max.
Current Rating	20A max.
Cable Cross Section Area	0,5mm ² ~ 2,5mm ²
Durability Voltage	1500VAC@60s.
Insulation Structure	500 MΩ at 500VDC
Contact Resistance	10 mΩ max.
Min Wire Size OD	6mm
Max Wire Size OD	10mm
Temperature Rating	-40°C ~ +85°C
IP Class	IP68 (10m / 60min)
Mold Material	PA6
Contact/Terminal Material	Nickel-Plated Brass

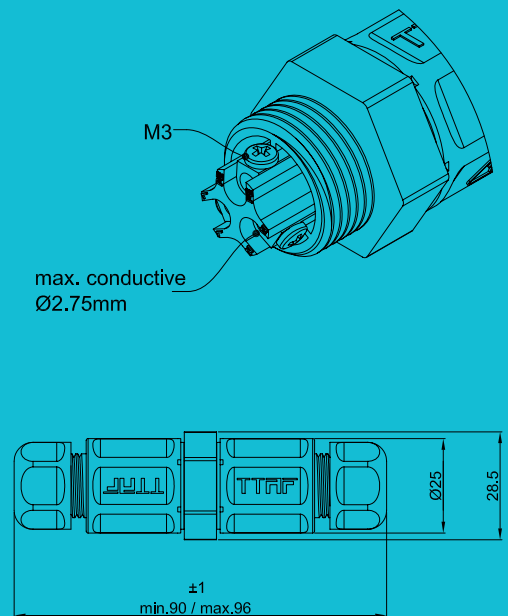

3 Pin I Type Push in Wire Field Assembly

WPK Series

Connector

3 pin
250 VAC
6A



GONTUANA
Waterproof Connector Series

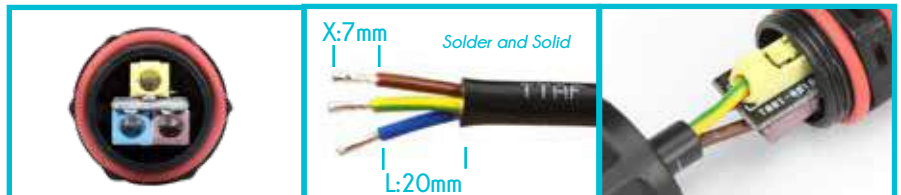

Technical Specifications

Number of Poles
Voltage Rating
Current Rating
Cable Cross Section Area
Durability Voltage
Insulation Structure
Contact Resistance
Min Wire Size OD
Max Wire Size OD
Operating Temperature
IP Class
Mold Material
Terminal Type
Contact Material
Seal Material

Product Code

WPK-0302M6

3
250VAC max.
6A max.
0,5mm² ~ 1,5mm²
1250VAC@60s.
1000 MΩ@1000V
12 mΩ
6mm
10mm
-40°C ~ +85°C
IP68 (10m / 60min)
PA6
Push Button Screwless Terminal
Phosphor Bronze, Tin-Plated
Silicone

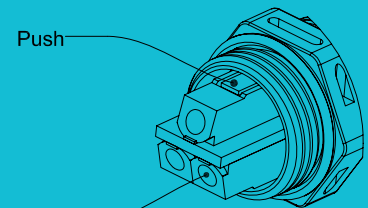

max. conductive
Ø1.5mm

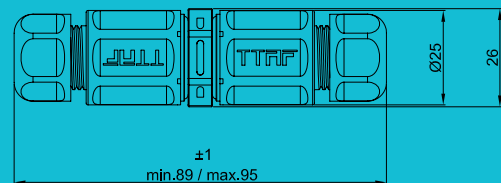

3 Pin Panel Type Screw Connection Field Assembly

WPP Series

Connector

3 pin
250 VAC
20A



GONTUANA
Waterproof Connector Series



Technical Specifications

Product Code

WPP-0302M20

Number of Poles	3
Voltage Rating	250VAC max.
Current Rating	20A max.
Cable Cross Section Area	0,5mm ² ~ 2,5mm ²
Durability Voltage	1500VAC@60s.
Contact Resistance	10 mΩ max.
Insulation Structure	500 MΩ at 500VDC
Min Wire Size OD	6mm
Max Wire Size OD	10mm
Temperature Rating	-40°C ~ +85°C
IP Class	IP68 (10m / 60min)
Mold Material	PA6
Contact/Terminal Material	Nickel-Plated Brass
Seal Material	Silicone
Chasis Hole Dia	Ø16mm
Chasis max. Thickness	3,5mm

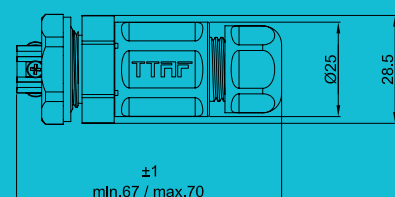
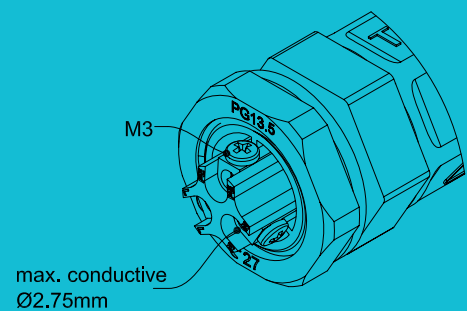

3 Pin T Type Screw Connection Field Assembly

WPT Series

3 pin
250 VAC
20A

Connector



CE EN 60309-1
EN 60695-2
EN 61984-2009



GONTUANA
Waterproof Connector Series

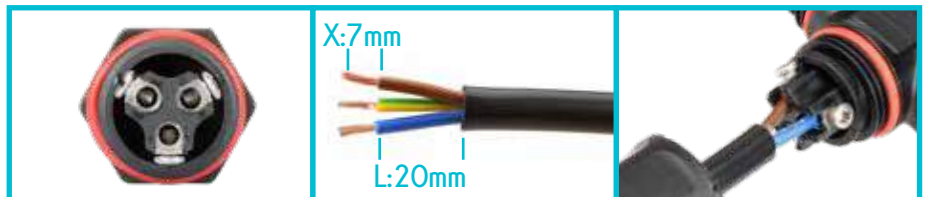

Technical Specifications

Product Code
WPT-0303M20

Number of Poles	3
Voltage Rating	250VAC max.
Current Rating	20A max.
Cable Cross Section Area	0,5mm ² ~ 2,5mm ²
Durability Voltage	1500VAC@60s.
Insulation Structure	500 MΩ at 500VDC
Contact Resistance	10 mΩ max.
Min Wire Size OD	6mm
Max Wire Size OD	10mm
Temperature Rating	-40°C ~ +85°C
IP Class	IP68 (10m / 60min)
Mold Material	PA6
Contact/Terminal Material	Nickel-Plated Brass
Seal Material	Silicone

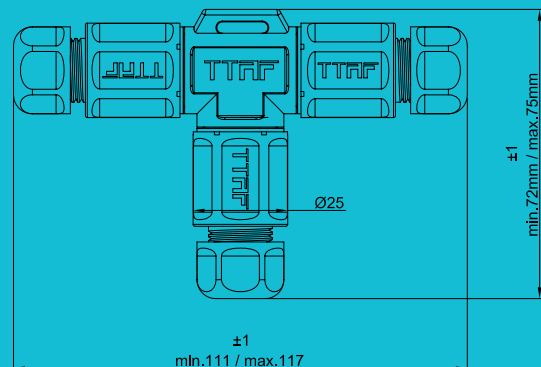
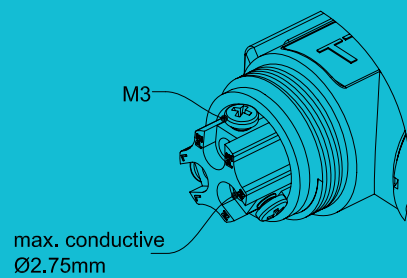

6 Pin Power I Type Screw Connection Field Assembly

Connector

WPI Series

6 pin
250 VAC
25A



GONTUANA®
Waterproof Connector Series



Technical Specifications

Product Code

WPI-0602M25

Number of Poles	6
Voltage Rating	250VAC max.
Current Rating	25A max.
Cable Cross Section Area	0,75mm ² ~ 4mm ²
Durability Voltage	1500VAC@60s.
Insulation Structure	1000 MΩ at 1000VDC
Contact Resistance	1 mΩ max.
Min Wire Size OD	10mm
Max Wire Size OD	14mm
Temperature Rating	-40°C ~ +85°C
IP Class	IP68 (10m / 60min)
Mold Material	PA6
Contact/Terminal Material	Nickel-Plated Brass
Seal Material	Silicone

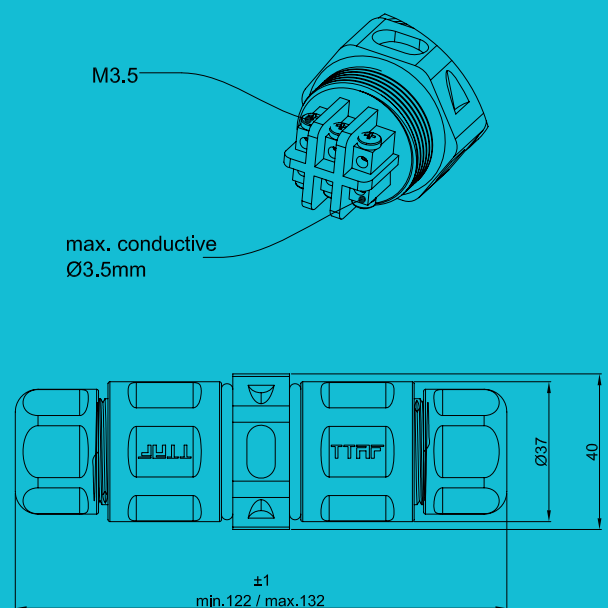

3 Power + 6 Data I Type Screw Connection Field Assembly

Connector

WPI Series

3 Power + 6 Data
250 VAC Power, 50 VDC Data
25A Power + 1A Data



Cable Code : KBL-9144

GONTUANA
Waterproof Connector Series

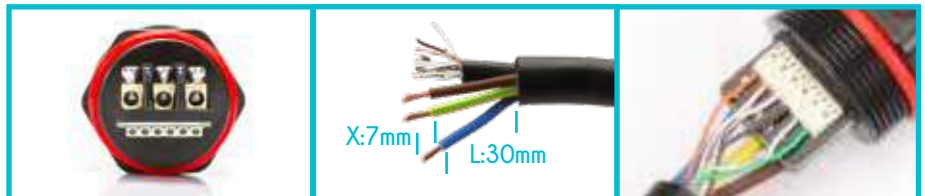

Technical Specifications

Number of Poles
Voltage Rating
Current Rating
Cable Cross Section Area
Durability Voltage
Insulation Structure
Contact Resistance
Min Wire Size OD
Max Wire Size OD
Temperature Rating
IP Class
Mold Material
Contact/Terminal Material
Seal Material

Product Code

WPI-3602M25

3 Power + 6 Data
Power: 250VAC max. + Data: 50 VDC/VAC
Power: 25A max. + Data: 1 Amper
Power: 2.5mm² - Data: 0,2mm²
1500VAC@60s.
1000 MΩ at 1000VDC
1 mΩ max.
10mm
14mm
-40°C ~ +85°C
IP68 (10m / 60min)
PA6
Nickel-Plated Brass
Silicon

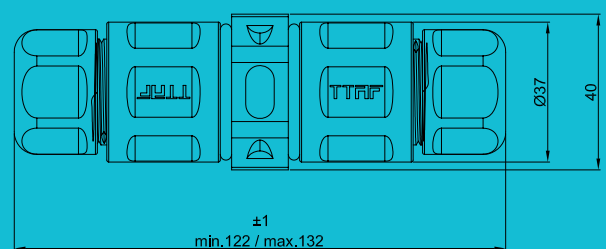
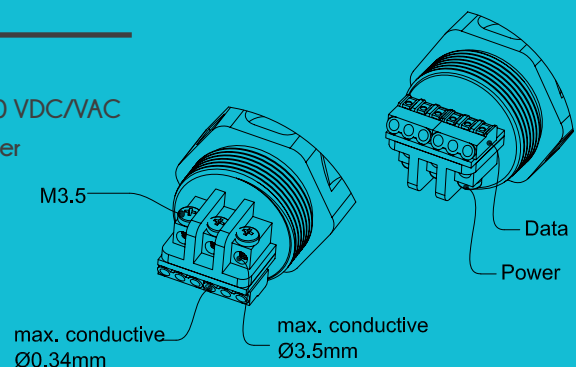

6 Pin Power T Type Screw Connection Field Assembly

Connector

WPT Series

6 pin
250 VAC
25A



GONTUANA
Waterproof Connector Series



Technical Specifications

Number of Poles
Voltage Rating
Current Rating
Cable Cross Section Area
Durability Voltage
Insulation Structure
Contact Resistance
Min Wire Size OD
Max Wire Size OD
Temperature Rating
IP Class
Mold Material
Contact/Terminal Material
Seal Material

Product Code WPT-0603M25

6
250VAC max.
25A max.
0,75mm² ~ 4mm²
1500VAC@60s.
1000 MΩ at 1000VDC
10 mΩ max.
10mm
14mm
-40°C ~ +85°C
IP68 (10m / 60min)
PA6
Nickel-Plated Brass
Silicone

